

UHF 300W Bandpass Filter

Product Specifications

BPF-8-VIII-300-NF / DF / 78

Part Number: 202668.01 / 202669.01 / 202670.01



Main Features

- 8 Pole
- 80mm Cavity Size
- Double Cross Coupling
- 18MHz Bandwidth Tunability
- Temperature Stabilization
- Output Monitor Probe

Electrical Specifications

Frequency range	174-240MHz
Insertion Loss	$f(0) \leq 0.8\text{dB}$
	$f(0) \pm 3\text{MHz} \leq 1.4\text{dB}$
Attenuation	$f(0) \pm 4\text{MHz} \geq 10\text{dB}$
	$f(0) \pm 4.5\text{MHz} \geq 18\text{dB}$
	$f(0) \pm 5\text{MHz} \geq 25\text{dB}$
	$f(0) \pm 6\text{MHz} \geq 45\text{dB}$
	$f(0) \pm 9\text{MHz} \geq 63\text{dB}$
Harmonic Attenuation	$\geq 60\text{dB}$ up to 1.1GHz
Return loss / VSWR	$\leq 23\text{dB}/1.15$
Group delay variation	$< 600\text{ns}$
Temperature Stability	$< 2\text{kHz/K}$
Max Power Output	300 W
Impedance	50 Ω

Environmental Specifications

Operating Temperature Range	-10°C to +55°C
Max Operating Temperature (Body)	65°C
Relative humidity	5% - 95%
Barometric pressure	55 KPa - 106KPa

anywavecom.net

300 Knightsbridge Parkway | Suite 150 | Lincolnshire | IL | 60069

Phone: +1 (847) 415 2258 Fax: +1 (847) 415 2112

UHF 300W Bandpass Filter

Product Specifications

BPF-8-VIII-300-NF / DF / 78

Part Number: 202668.01 / 202669.01 / 202670.01



Mechanical Specifications

Connectors (Input / Output)	N female	202668.01
	DIN female	202669.01
	7/8" EIA	202670.01
Output Monitor Probe	SMA female	
Weight	6kg	
Outer Dimension (mm)	342 * 174 * 150mm	
Mounting	Wall	
Packing	1 Piece per box	

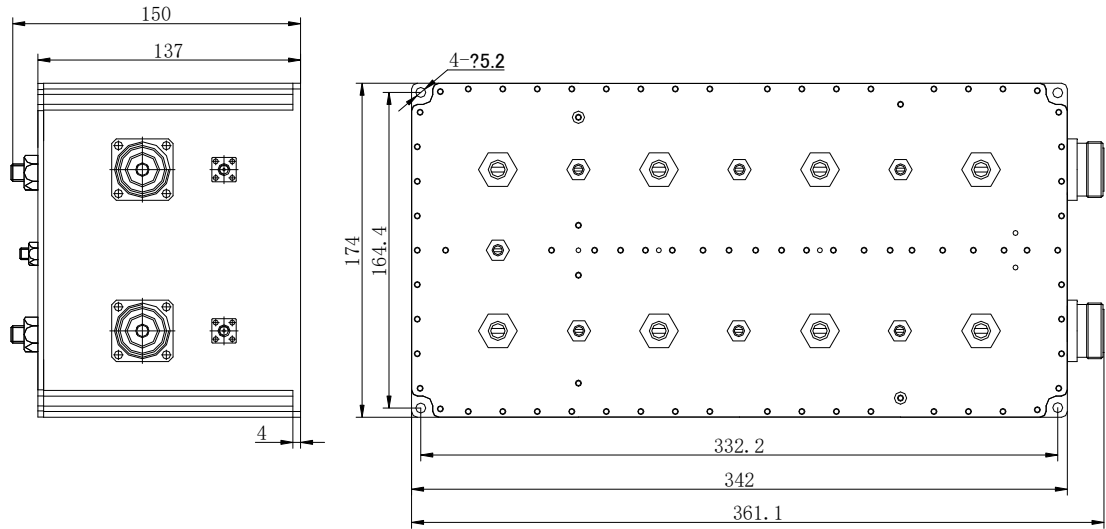

anywavecom.net

300 Knightsbridge Parkway | Suite 150 | Lincolnshire | IL | 60069

Phone: +1 (847) 415 2258 Fax: +1 (847) 415 2112