

UHF 350W Bandpass Filter

Product Specifications

BPF-8-U-350-NF / DF / 78

Part Number: 202628.01 / 202629.01 / 202630.01



Main Features

- 8-Pole
- 90mm Cavity Size
- Double Cross Coupling
- 18MHz bandwidth Tunability
- Temperature Stabilization
- Output Monitor Probe

Electrical Specifications

Frequency Range	470-806MHz		
Adjusting Data	DVB-T/T2	ATSC 1.0/3.0	ISDB-T
Insertion Loss	f(0):≤0.65dB	f(0):≤0.75dB	f(0):≤0.85dB
	f(0)±3.8MHz:≤1.45dB	f(0)±2.7MHz:≤1.3dB	f(0)±2.79MHz:≤1.6dB
	f(0)±3.9MHz:≤1.75dB	f(0)±2.93MHz:≤1.6dB	
Attenuation	f(0)±4.2MHz:≥4dB	f(0)±3.5MHz:≥10dB	f(0)±3.15MHz:≥7dB
	f(0)±6.MHz:≥30dB	f(0)±6.MHz:≥48dB	f(0)±4.5MHz:≥31dB
	f(0)±12MHz:≥51dB	f(0)±9MHz:≥65dB	f(0)±9MHz:≥61dB
Harmonic Attenuation	≥70dB	≥70dB	≥70dB
Return Loss / VSWR	≤-25dB/1.12	≤-23dB/1.12	≤-23dB/1.12
Temperature Stability	≤2kHz/K		
Max Power Output	350W		
Directional Coupler			
Coupling	50±0.8dB		
Directivity	≥23dB		
VSWR	≤1.2		
Impedance	50Ω		

Environmental Specifications

Operating temperature range	-10°C to +55°C
Max Operating Temperature (Body)	65°C
Relative humidity	5% - 95%
Barometric pressure	55KPa -106KPa

anywavecom.net

300 Knightsbridge Parkway | Suite 150 | Lincolnshire | IL | 60069

Phone: +1 (847) 415 2258

Fax: +1 (847) 415 2112

UHF 350W Bandpass Filter

Product Specifications

BPF-8-U-350-NF / DF / 78

Part Number: 202628.01 / 202629.01 / 202630.01



Mechanical Specifications

Connectors: Input; Output	DIN female or 7/8" EIA or 1 5/8" EIA
Output Monitor Probe	N female
Weight	6kg
Outer Dimension(mm) (including connectors and mounting feet)	471.7*195.5*87mm (DIN-F) 479.5*195.5*87mm (7/8-F)
Mounting	Wall or pole
Packing	1Pce in box

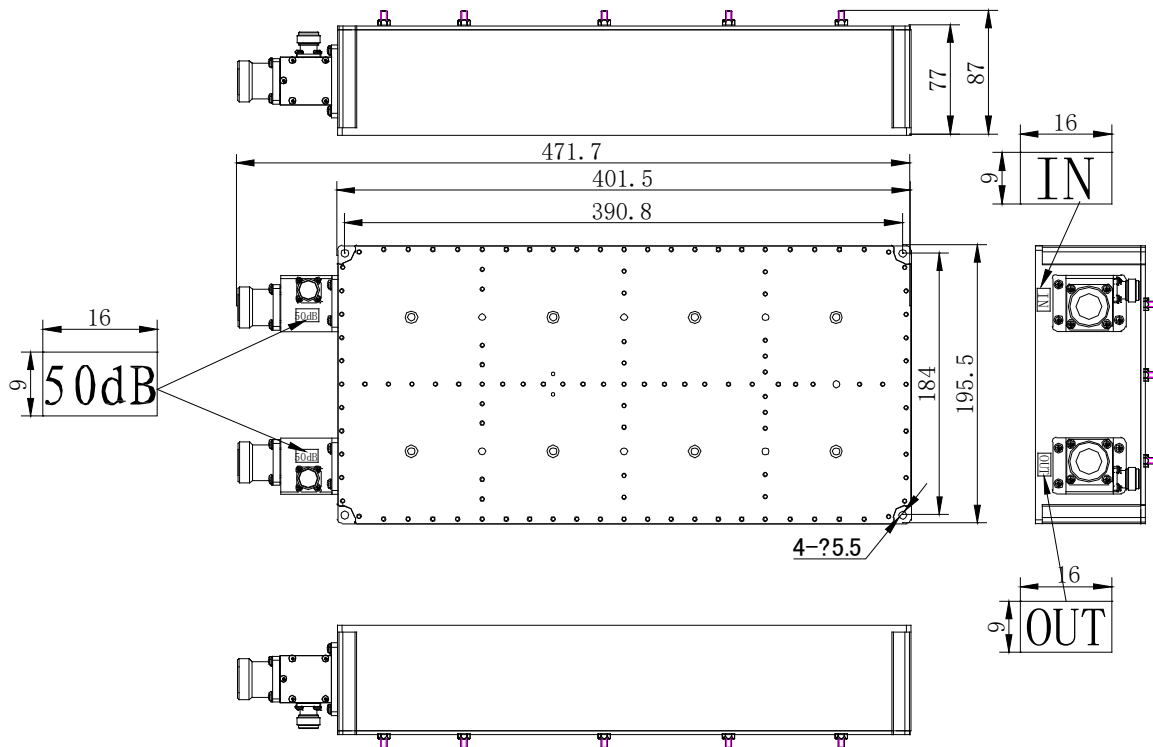

350W 8 Pole DIN-F Filter

anywavecom.net

300 Knightsbridge Parkway | Suite 150 | Lincolnshire | IL | 60069

Phone: +1 (847) 415 2258

Fax: +1 (847) 415 2112

UHF 350W Bandpass Filter

Product Specifications

BPF-8-U-350-NF / DF / 78

Part Number: 202628.01 / 202629.01 / 202630.01

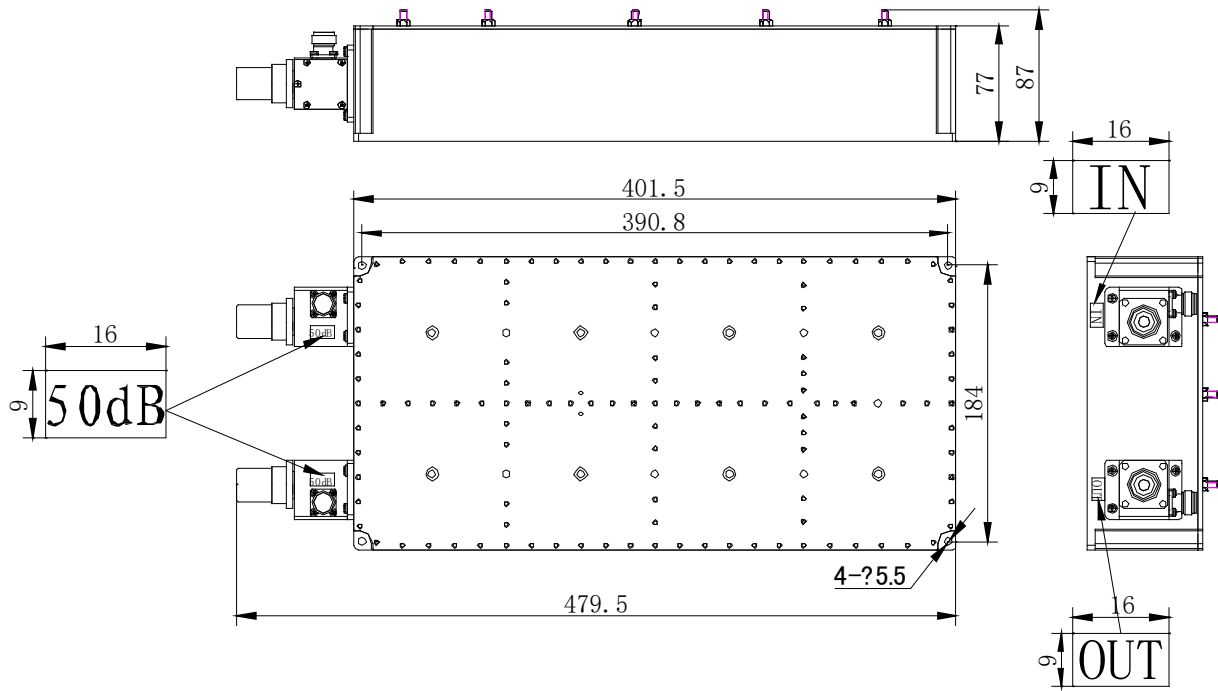

350W 8 Pole 7/8-F Filter

anywavecom.net

300 Knightsbridge Parkway | Suite 150 | Lincolnshire | IL | 60069

Phone: +1 (847) 415 2258

Fax: +1 (847) 415 2112